

The Jane Stickle Quilt - Block H7

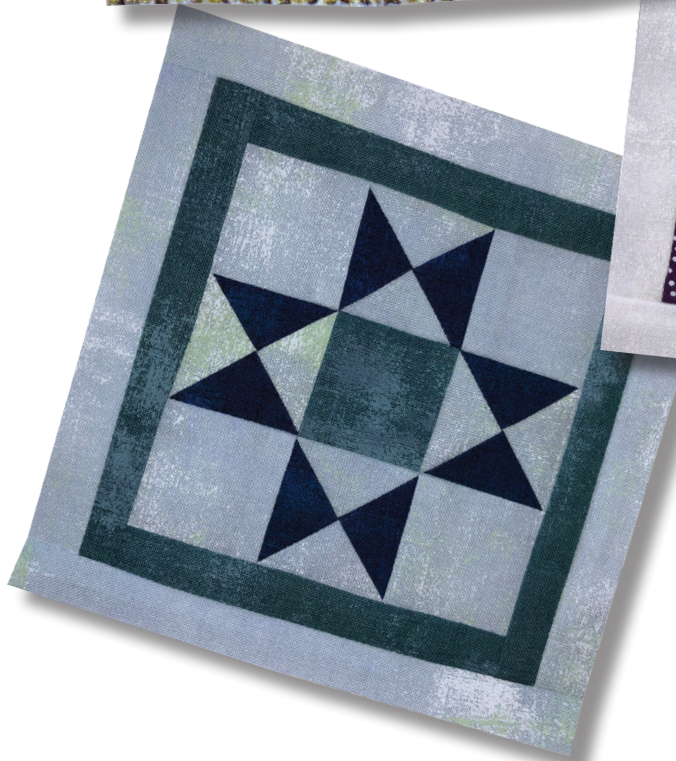

What you need:

Patches	Quantity/size
A*	(2) 1" x 6"
B*	(2) 1" x 5"
C	(2) 7/8" x 5"
D	(2) 7/8" x 4¼"
E	(4) 1¾" x 1¾" - light blue (1) 1¾" x 1¾" - green
F	(2) 2½" x 2½" - light blue (2) 2½" x 2½" - navy

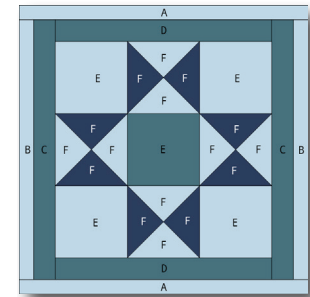

Hobbystash Colorway

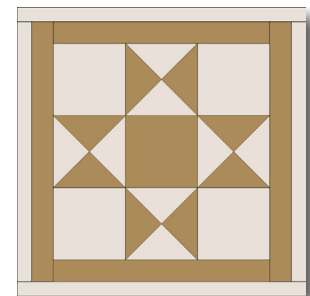

Jane Stickle Colorway

**The actual required width for Unit A and Unit B units is ¾". The increased width specified above allows for squaring the block to exactly 5½".*

Assembly:

- Referring to BASIC INSTRUCTIONS, make 4 HST units using the Unit F patches.
- On the reverse side of one HST unit, draw a diagonal line from corner to corner opposite the seam. Align with second HST unit right sides together, with contrasting colors facing each other. Sew two seams, each 1/4" away from drawn line. Cut apart on the drawn line and press open. Repeat the process for a total of 4 quarter-square triangle (QST) units. The QST units should measure 1¾" x 1¾" square.
- Sew a light blue Unit E to each side of two QST units. Sew the remaining QST units to each side of green Unit E as shown.
- Join Unit D to the top of the block, and then the bottom.
- Join Unit C to the right side of the block, and then the left.
- Join Unit B to the right side of the block, and then the left.
- Join Unit A to the top of the block and then the bottom. Square up block to measure 5½" x 5½" square.

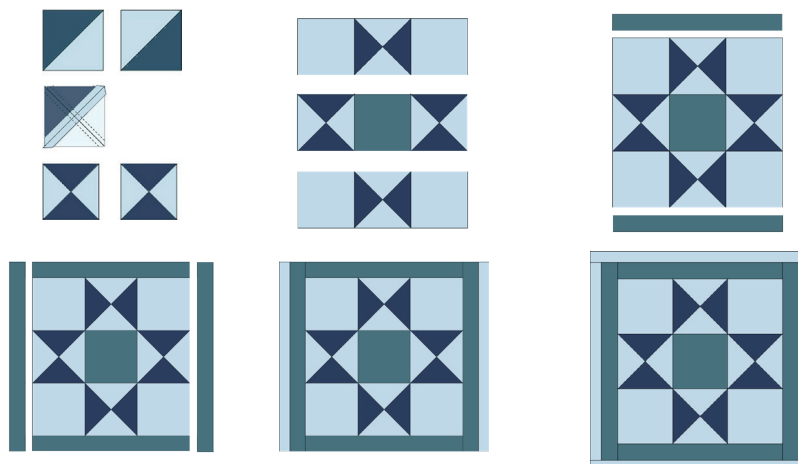

SET PRINTER TO "ACTUAL SIZE" WHEN PRINTING THIS PAGE.

